

Valkyrie Mobile Device Management

1. Before setting up Valkyrie email on your cell phone, verify your device meets the following requirements:
 - Has at least a 6-digit unlock passcode enabled
 - Is encrypted (applicable for Android devices)
 - Is not jailbroken
2. Once verified, download the “Intune Company Portal” and “Microsoft Outlook” apps. The app icons are shown below.

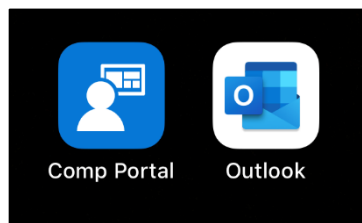
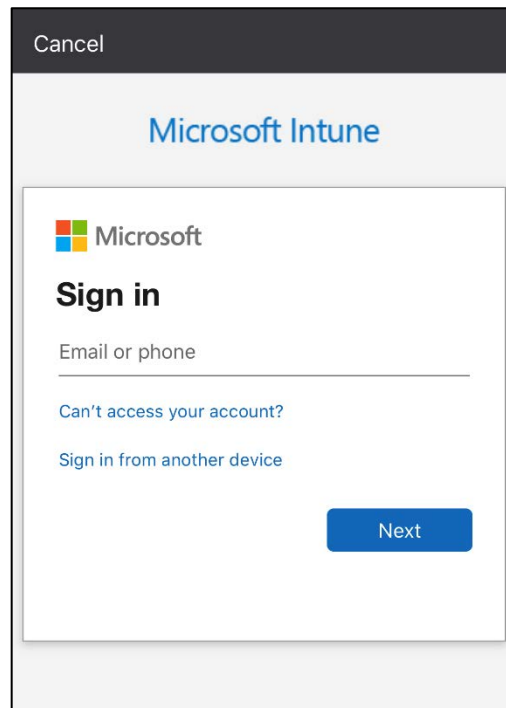

3. Once the apps are downloaded, open the “Comp Portal”. You will be shown a blank sign in window. Enter your Valkyrie email address (firstname.lastname@valkyrie.com).

The screenshot shows a mobile application interface for Microsoft Intune. At the top, there is a dark grey bar with the word 'Cancel' in white. Below this is a light grey header with the text 'Microsoft Intune' in blue. The main content area is white and contains the Microsoft logo (four colored squares) followed by the word 'Microsoft'. Below the logo is the heading 'Sign in' in bold black text. Underneath is a text input field with the placeholder text 'Email or phone'. Below the input field are two links: 'Can't access your account?' and 'Sign in from another device'. At the bottom right of the white area is a blue button with the text 'Next' in white.

4. You will then need to sign in with your Valkyrie 16+ character domain/email password followed by your multifactor authentication (MFA) passcode.

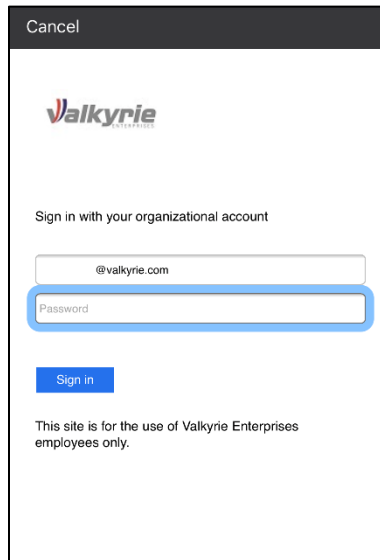

Cancel

Valkyrie
ENTERPRISE

Sign in with your organizational account

@valkyrie.com

Password

Sign in

This site is for the use of Valkyrie Enterprises employees only.

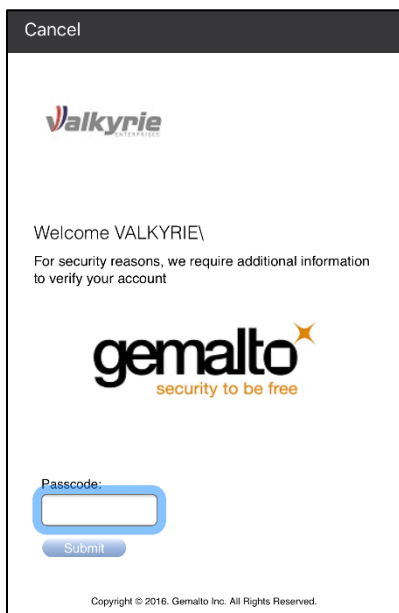

Cancel

Valkyrie
ENTERPRISE

Welcome VALKYRIE\
For security reasons, we require additional information to verify your account

gemalto
security to be free

Passcode:

Submit

Copyright © 2016. Gemalto Inc. All Rights Reserved.

If you have a **physical token**, enter your 4-digit pin followed by the 6-digit code that the token displays.

If you have the **MobilePass app**, enter the 6-digit code that the app generates.

5. After it loads the company resources, you will have to select “Begin” and go through the enrollment process. See screenshots below.

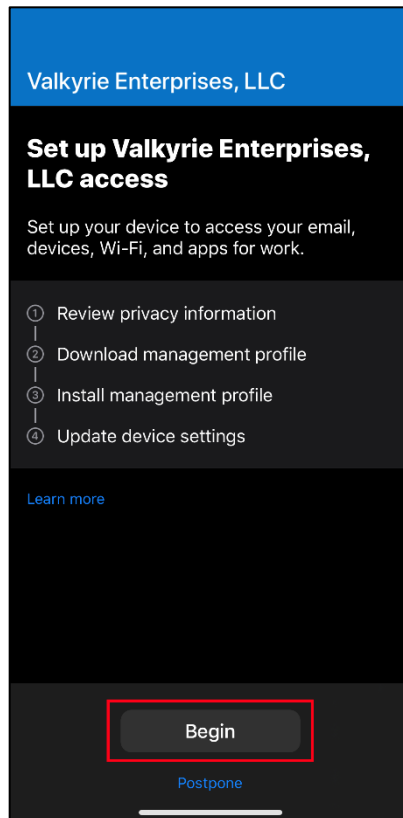
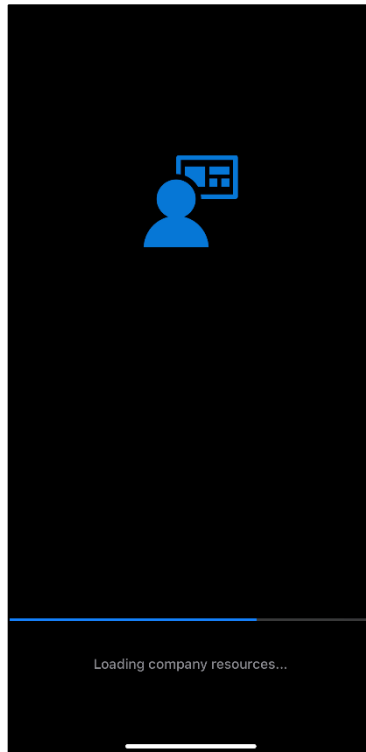

[← Back](#)

Device management and your privacy

Here is what Valkyrie Enterprises, LLC can and cannot see or do on your device.

Can't

Can



- View browsing history on this device
- See your personal emails, documents, contacts, or calendar
- Access your passwords
- View, edit or delete your photos
- See the location of a personal device

[Learn more](#)

Continue

Valkyrie Enterprises, LLC

Set up Valkyrie Enterprises, LLC access

Set up your device to access your email, devices, Wi-Fi, and apps for work.

- ✓ Review privacy information
- ② Download management profile
- ③ Install management profile
- ④ Update device settings

[Learn more](#)

Continue

[Postpone](#)

Cancel  portal.manage.microso AA 

Valkyrie Enterprises, LLC

Download management profile

When prompted, select **Allow** to download the profile.

After it downloads, select **Done** to continue.

Downloaded the management profile? Continue now.

This website is trying to download a configuration profile. Do you want to allow this?

Ignore

Allow

[Valkyrie Enterprises, LLC Privacy Terms](#) [Feedback](#)



Valkyrie Enterprises, LLC

Download management profile

When prompted, select **Allow** to download the profile.

After it downloads, select **Done** to continue.

Downloaded the management profile? [Continue now.](#)

Profile Downloaded

Review the profile in Settings app if you want to install it.

Close

****STEPS #6, 7, AND 8 ARE FOR iPhones****

- At this point, go into the "Settings" app. Leave the "Comp Portal" app running. Select "General" > "Profile".

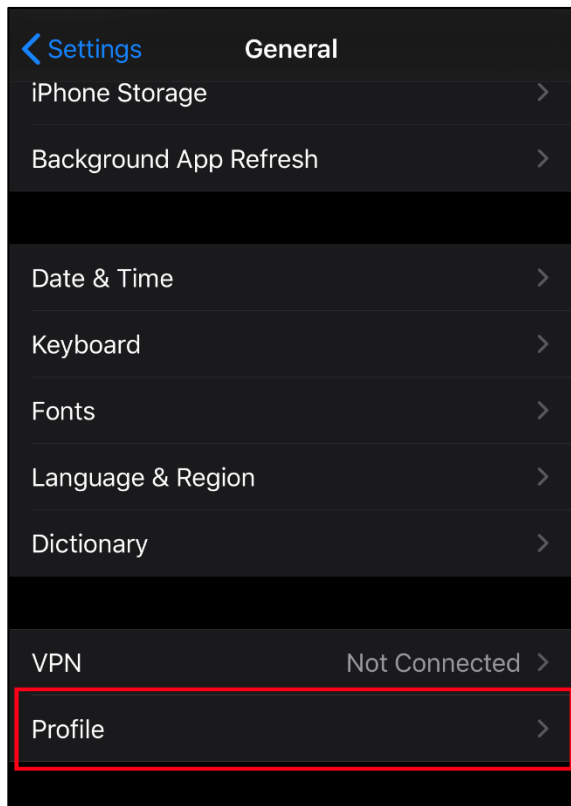
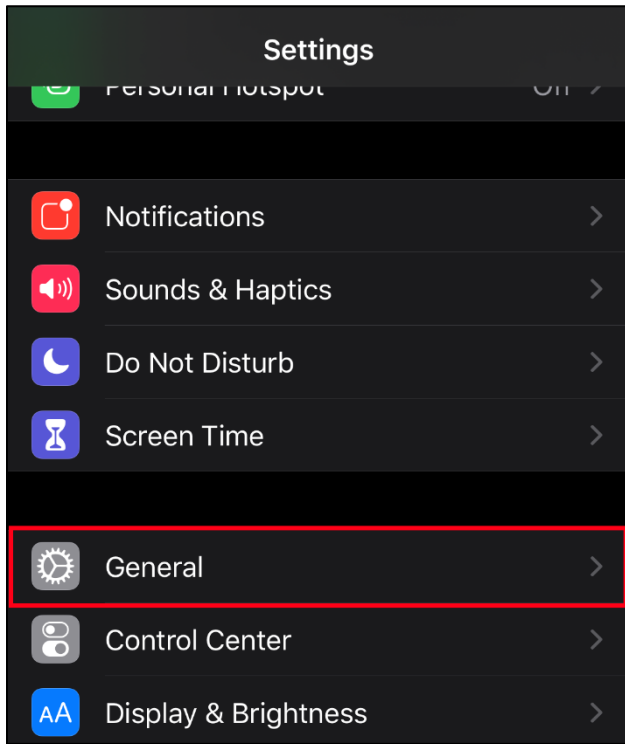

- Select the management profile shown in the list. Then select "Install". You may be prompted to enter your 6-digit phone unlock passcode.

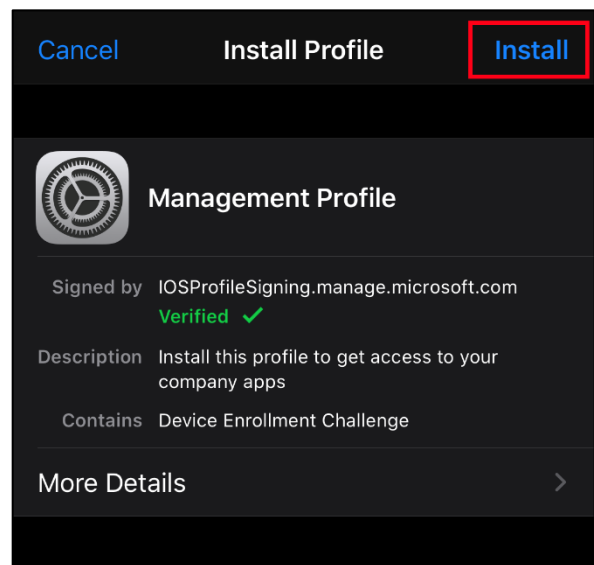
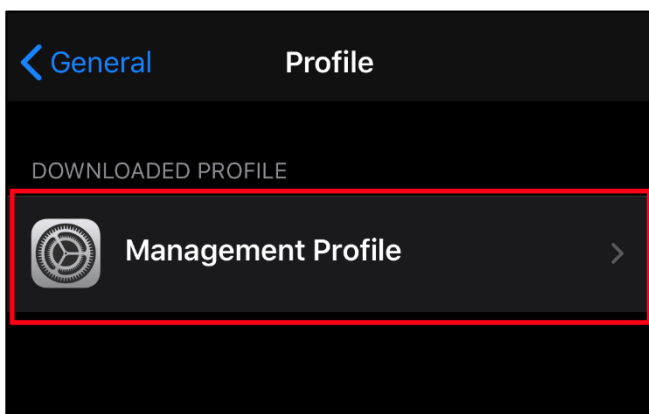

8. Then select "Install" > "Install" > "Trust".

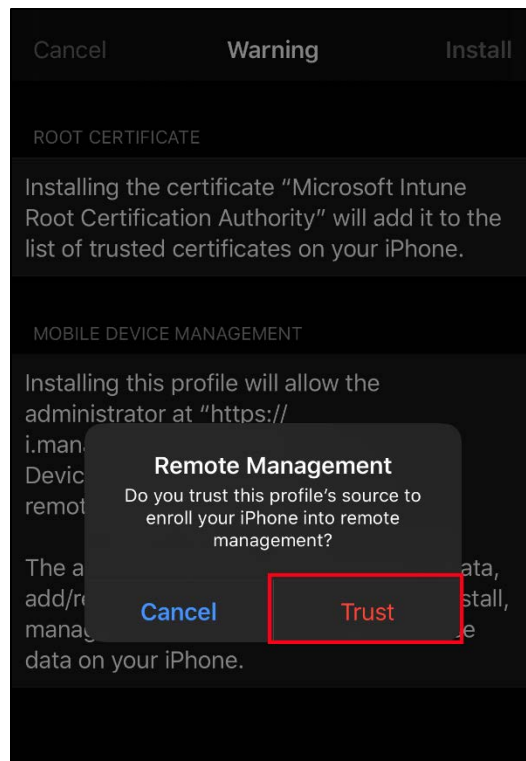
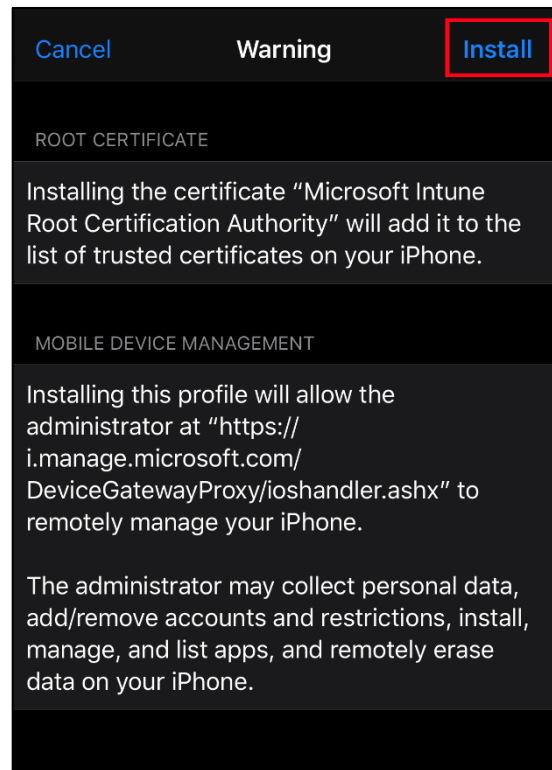
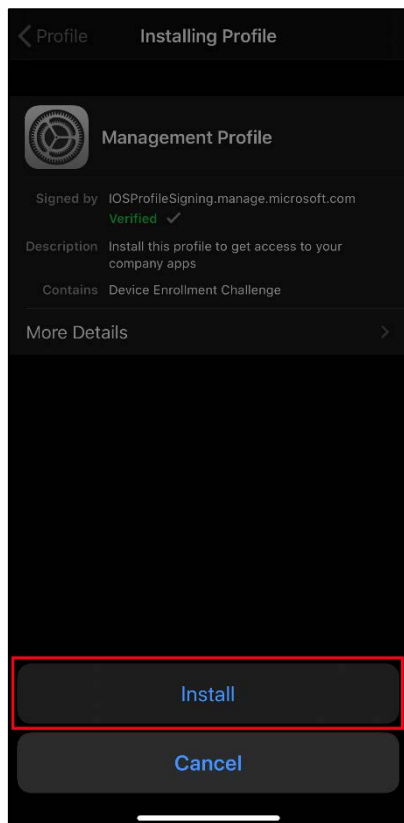

9. Once that management profile is installed, return to the “Comp Portal” app and continue with the enrollment process.

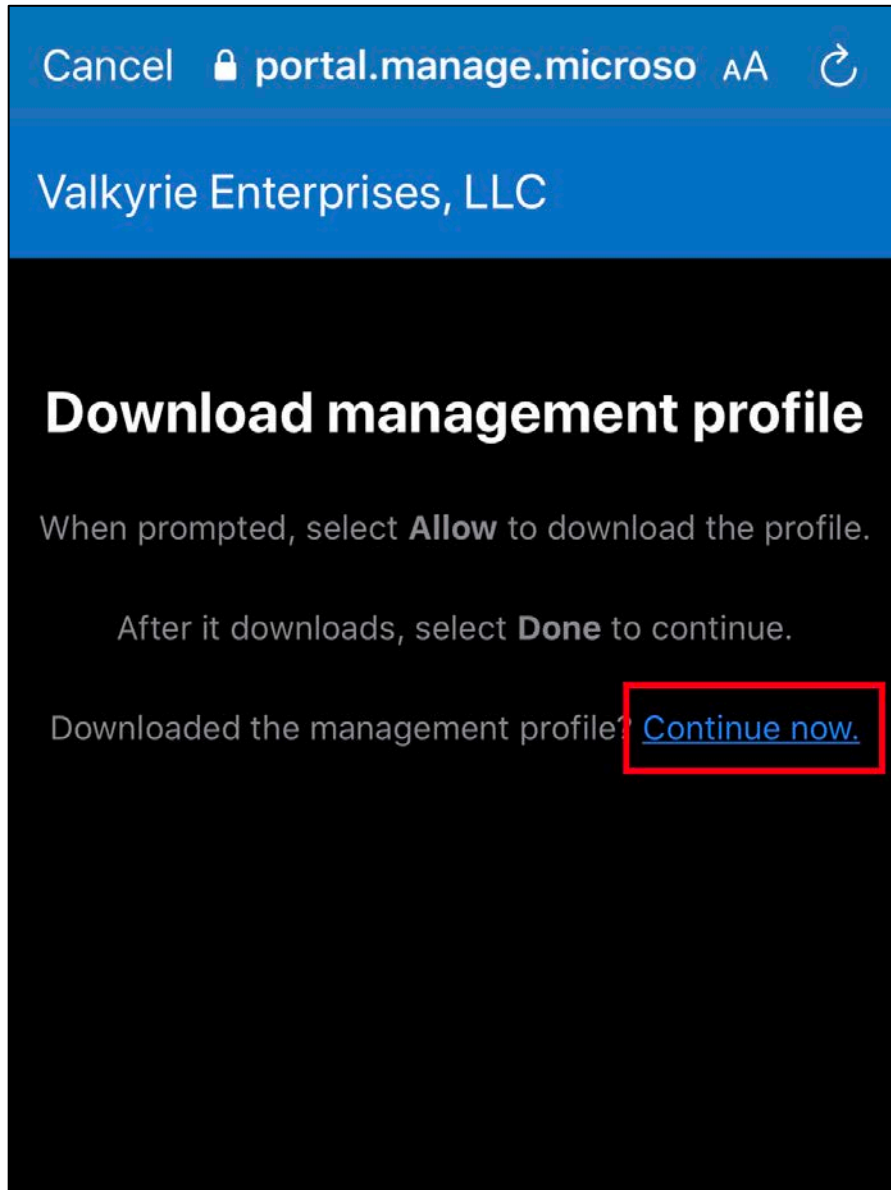

Valkyrie Enterprises, LLC

Set up Valkyrie Enterprises, LLC access

Set up your device to access your email, devices, Wi-Fi, and apps for work.

- ✓ Review privacy information
- ✓ Download management profile
- ✓ Install management profile
- ④ Update device settings

[Learn more](#)

Continue

[Postpone](#)

 Back

Confirming device settings...

This may take a few minutes. You can do other things on your device while Valkyrie Enterprises, LLC device setup completes.

Confirming device settings...



Valkyrie Enterprises, LLC

You're all set!

You should now have access to your email, devices, Wi-Fi, and apps for work.

- ✓ Review privacy information
- ✓ Download management profile
- ✓ Install management profile
- ✓ Update device settings

[Learn more](#)

Done

10. After you see the “You’re all set!” window and select “Done”, you can close the Comp Portal app and open Microsoft Outlook. It should already recognize your account and display your Valkyrie email. Select “Add Account”. If you see the message “US government account detected” then it added your account successfully. Select “OK” to close the app. When you reopen Microsoft Outlook, your Inbox will be shown and you will be complete.

